

TECTRON (R) Tubular anode cells for electrophoretic paints

LONG LIFE

*BETTER
THROWPOWER*

FLEXIBLE

ECONOMIC



Tectron cells are manufactured in The Netherlands in a wide variety of qualities, dimensions and options; the ideal mix of product properties can be optimized for each individual electrocoat plant .

TECTRON tubular anode cells use a licensed technology for the internal anolyte flowpattern. This feature makes that a relatively high percentage of the ion exchange membrane is available for the electrical current, which is an important quality aspect of anode cells. The chance that biological and corrosion sediments will blind the ion exchange membrane is reduced. Tectron anodes are heatsealed twice, achieving almost absolute reliability.

Accessories such as mounting supports, flowindicators and blocking diodes are available to make installation easy; Membracon can also assist in design of the anode system.

**MEMBRACON
FILTRATION B.V.**

Wittendijk 2
7216 pl KRING VAN DORTH
Netherlands

Chamber of Commerce 08074455

Tel.: +31 573 432110

Fax: +31 573 432112

E-mail: info@membracon.com

Website: www.membracon.com

LICENSED TECHNOLOGY



MAIN CHARACTERISTICS

| | T1 | T2 | T5 |
|----------------------|------------------------|------------------------|------------------------|
| Electrode diameter | 48 mm | 60,3 mm | 143 mm |
| Electrode area/meter | 0,15 m ² /m | 0,19 m ² /m | 0,45 m ² /m |

SUMMARY OF AVAILABLE OPTIONS

MEMBRANE SHELL

Diameter T1, T2, T5
(see table)

Membrane type LKAN
(standard) or
PTAN (premium)

Open top or Closed top

Splash guard

Membrane Guard

Bumper

ELECTRODE

Diameter T1, T2, T5
(see table)

Wall thickness S40
(standard) or S10

Electrode from welded tube
(standard) or seamless

Stainless Steel quality AISI
316L (1.4404) is standard,
other stainless steel qualities
Or Titanium (coated)

Diode

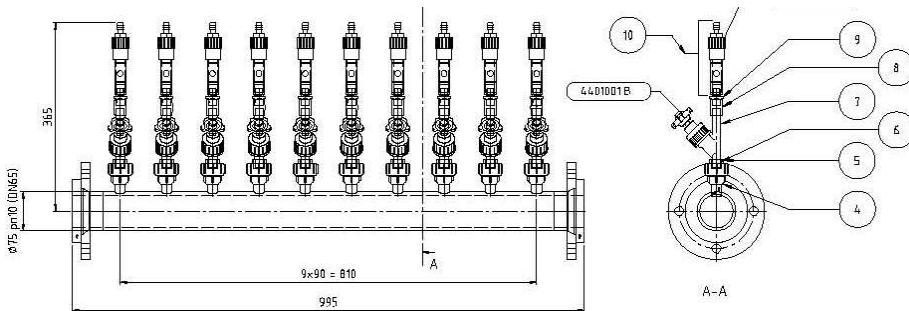
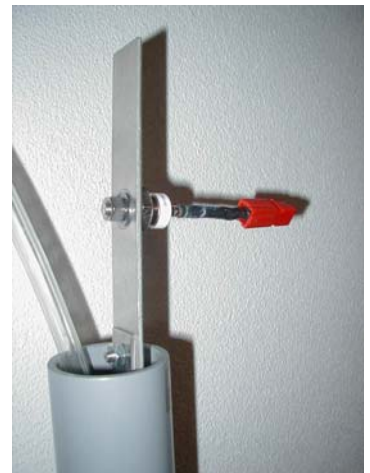

Above: Distribution manifold for Anolyte
Below: Examples of customized mounting Supports

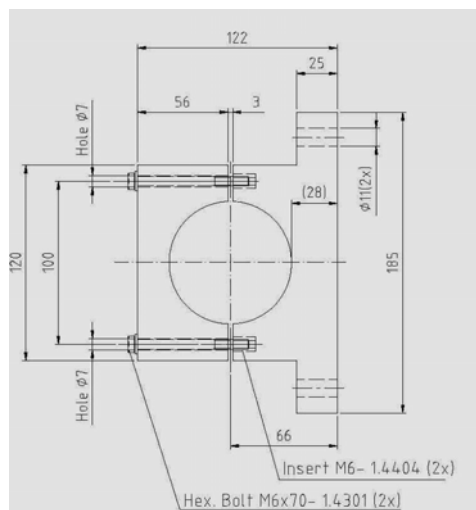
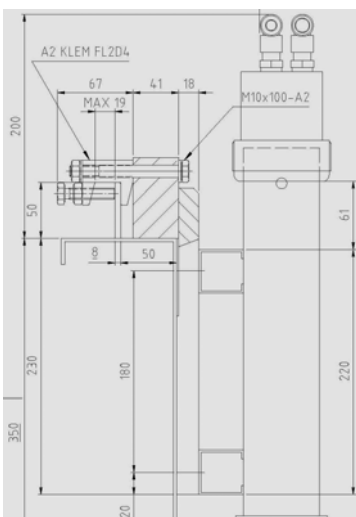

The pictures shown on this page show some of the available options and accessories for Tectron anode cells.

From top to bottom:

Guard for protection against mechanical damage

Bumpers for reduced movement behind a crash rail

Closed top

Diode with heat sink